

Stor & Roto Wall Light Installation Instructions



Product Specifications

Model No.	HV36003T-BLK	HV36012T-BLK
Name	Roto	
Material	Aluminium + PC Diffuser	
Colour	Black	
Installation Type	Wall or Ceiling	Wall
IP Rating	IP54	
Protection Class	1 (240v Requires Earth) ⚡	
Input Voltage	240v AC	
Lamp Base	Built in LED	
Lamp Wattage	1x 10w	
Colour Temp	TRI Colour - 3000k, 4000k, 5500k	
Lumens	520lm, 600lm, 570lm	360lm, 410lm, 390lm
CRI	> 80	
Wiring	Parallel	
Dimmable	No	
Warranty	3 Years Replacement*	

HV36003 Dimensions

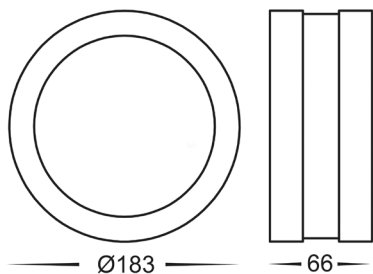

HV36012 Dimensions

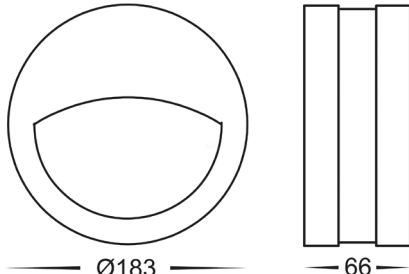

HV36003 + HV36012 Mounting Base Dimensions

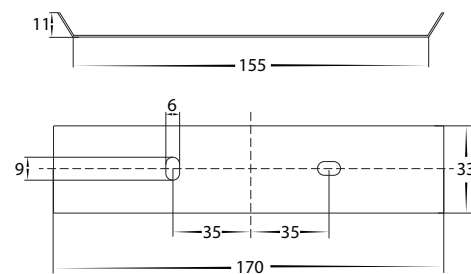

Important Safety Issues:

- This product must be installed by a qualified electrician according to AS/NZS 3000.
- Ensure all electrical mains are disconnected before any installation.
- Modification of this product will void any warranty.
- Havit Lighting does not take responsibility for wrong installation, incorrect use, or use of installation material that does not belong to the system.
- Aluminium and 304SS fittings must not be installed within 5km of any salt water environments.
- All o-rings and seals must be in place correctly to maintain warranty
- This form may be updated at any time due to product improvements, please check online installation form for most current version.

Steps for Installation:

1. Make sure that the electrical circuit is free of voltage (master switch off)
2. Remove screws from side of fitting and remove mounting bracket
3. Connect the cable - Use wire with earth; connect the earth first, then live and neutral wire.
4. Cover connections using an adhesive lined heat shrink or gel cap to make connection watertight. Failure to do this will void warranty.
5. Heat the heat shrink or crimp the gel cap making sure all connections are covered.
6. Install mounting bracket to wall or ceiling dependant on model chosen in desired location using appropriate screws for application.
7. Fitting is preset to 3000k, to change remove 4x screws on back of fitting and set aside.
8. Remove cover and slide switch located on front of PCB to desired colour temperature.
9. Reattach cover by reinserting 4x screws making sure these are tight to avoid water penetration.
10. Attach fitting to mounting bracket by inserting 2x screws on side of fitting to mounting bracket.
11. Apply silicon around edge of fitting to prevent any water from getting inside to electrical connections.
12. All connections must be carried out carefully, inspect all contacts before switching back on the electric circuit.

Must be installed by a licensed electrician

Contact Details:

143 Beauchamp Road
Matraville NSW 2036
Australia

Tel: 02 9381 8300
Fax: 02 9666 8881
Email: sales@havit.com.au
Web: www.havit.com.au

Warranty Terms & Conditions*



Additional Information

