

CV LED Wireless + DMX Driver

- Support RF 2.4GHz wireless signal and DMX wired connection.
- Can connect dimming, color temperature, RGB, RGBW, RGBWY lamps.
- Compatible with F series remote, RC4-RF-B remote and Q series remote.
- Compatible with EX series touch panel.
- Compatible with WiFi-106 / WiFi-108 gateway.



FC CE RoHS warranty 3 years ISO9001:2008

System Diagram

L-BUS

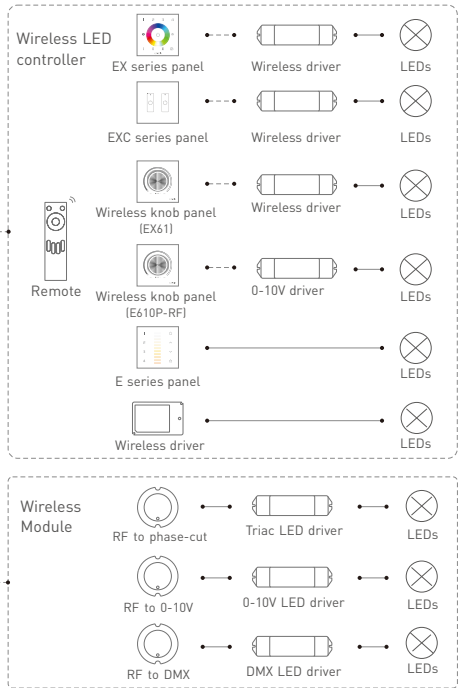
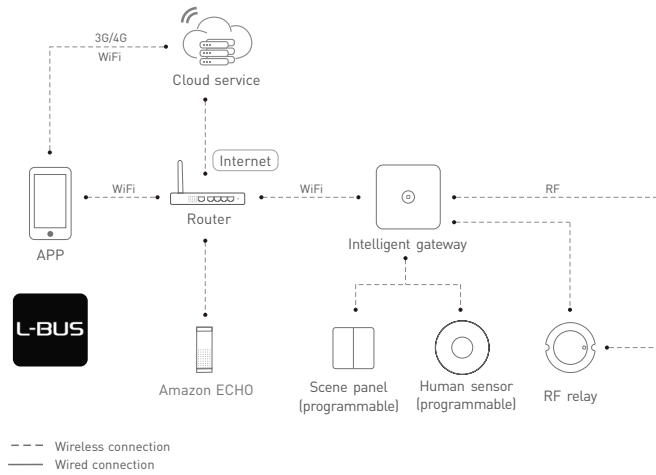

Specification

Model	F4-DMX-5A	F5-DMX-4A
Dimming interface	DMX/RDM	
Wireless signal	RF 2.4GHz	
Input voltage	5-24Vdc	
Output voltage	5-24Vdc	
Current load	5A×4CH Max. 20A	4A×5CH/5A×4CH Max. 20A
Output power	(0-25W...120W)×4CH Max. 480W	(0-20W...96W)×5CH Max. 480W
Protection	Short circuit / Over current / Reverse connection protection	Short circuit / Over current / over-heat / Reverse connection protection
Working temperature	-30°C-55°C	
Product size	L175×W44×H30(mm)	
Package size	L178×W48×H33(mm)	
Weight[G.W.]	130g	

Product Size

Unit: mm

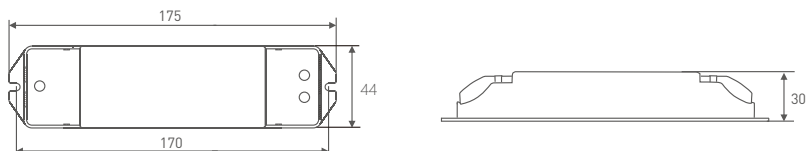

Terminal Description

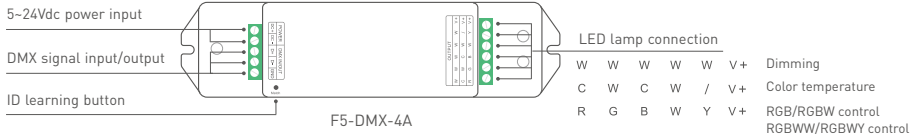

Match Code

Match code (ID learning button method):

Step 1:

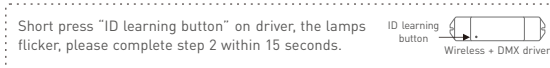

Step 2:

Match code with F series remote:
 Single zone remote: Long press On/Off key.
 Multi-zone remote: Long press the matching zone's ON & OFF keys simultaneously.

Match code with Q series or RC4-RF-B remote:
 Long press the matching zone's ON key.

Match code with EX series panel:
 Single zone panel: Long press On/Off key, then press any key.
 Multi-zone panel: Long press On/Off key, then press the matching zone key.
 * Please match code it when panel is power-on.

Match code with gateway:
 Turn on APP, enter "zone set" interface, click the right top "MATCH" key, then follow the prompts.

Match code (power on method):

Step 1:



Step 2:

Match code with F series remote:
 Single zone remote: Hold down On/Off key, meanwhile the driver power on.
 Multi-zone remote: Hold down the matching zone's On & Off keys simultaneously, meanwhile the driver power on.

Match code with Q series or RC4-RF-B remote:
 Hold down the matching zone's ON key, meanwhile the driver power on.

Match code with EX series panel:
 A. Single zone panel: Long press ON/OFF key until all indicator flicking.
 Multi-zone panel: Long press ON/OFF key until all zone's indicator flicking.
 B. The driver power on, the lamps flicker slowly, please complete step c within 15s.
 C. Single zone panel: Press any key on panel.
 Multi-zone panel: Press the matching zone key.
 * Please match code when panel is power-on.

Match code with gateway:
 Turn on APP, enter "zone set" interface, click the right top "MATCH" key, then follow the prompts.

Step 3:

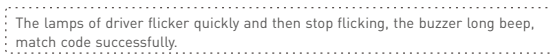

Step 3:

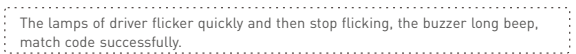

Match code with other gateway, please operate according to APP's prompts.

Clear Code:

Clear Code (ID learning button method):



Clear Code (power on method):

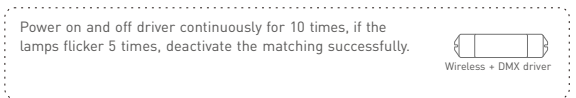

DMX Wiring Diagram

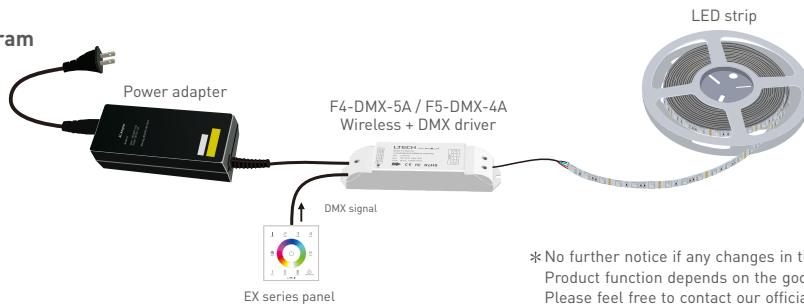

* No further notice if any changes in the manual.
 Product function depends on the goods.
 Please feel free to contact our official distributor if any question.